

Native flowering shrubs - Viburnum

Staff Car Park

Maple - Crimson King
Maple - Norway
Maple - Crimson King

School garden:
Existing walls painted, timber panels added between pillars to enclose the space and support climbing plants

Outdoor teaching area: existing timber shade structures to be re-used or replaced to provide shelter

Existing slope: Bamboo removed, area seeded with wildflower and managed to encourage a species-rich sward 'Totem' carvings made from felled timber set with the grassland

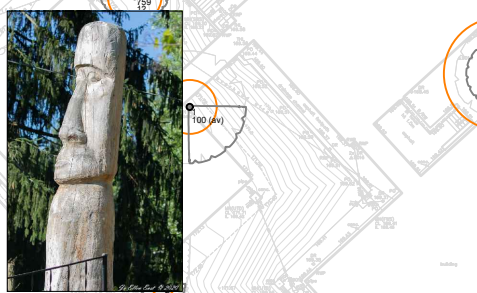

'Totem' carvings

Existing trees to be managed:
Selective coppicing, pruning and removal of dead branches
Stacks of dead wood to be retained in suitable locations as habitat piles

Swale extended into flat area

Ash with dieback - to be removed

Wildflowers

MUGA

Ramp

Wildflowers

Lawsone cypress

Lawsone cypress

Access to Respite Centre

Cherry

Cherry

Cherry

Wildflowers

New decorative shrub and tree planting

Sports Hall

Entrance

Bikes

Staff and Visitor Car Park

Species rich grassland

New specimen trees

New ramp for access with landings and seating. Marginal areas to be seeded with wildflowers and managed to encourage a species rich sward - New specimen trees - Oak and Beech

Existing Cypress trees retained

Selective management of existing shrubs and interplanted where required with flowering shrubs

Wildflowers

New decorative shrub and tree planting

The swale ditch areas will be seeded with a proprietary wetland grass mix and its margins will be planted with native damp/wetland species of perennials and small shrubs. These will include Dogwood, Guelder Rose, Meadowsweet, Flag Iris, Marsh Marigold, Purple and Yellow Loosestrife and Ferns



WW2 relic

Existing trees
Management and clearance - selective coppicing, pruning and removal of dead branches

Boundary with Penllwyn Lane
New native hedge to rear of railings. Area between hedge and car park managed as wildflower grassland



Wildflowers create a bio-diverse habitat supporting birds, mammals, bees, butterflies and other invertebrate species.

Tree Key

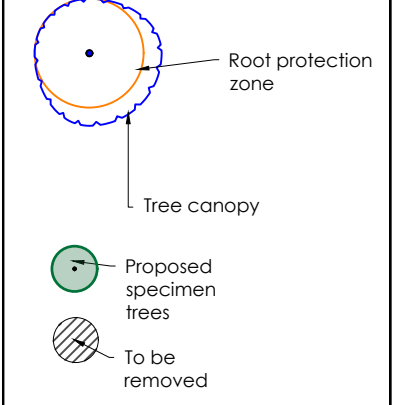

Rev:	Date:

HAIRE LANDSCAPE CONSULTANTS

UPPER BRECHFA LLANDEFALLE
BRECON POWYS LD3 0NG
Tel. 01874 754066
Email: mike@hairelandscapeconsultants.co.uk
Website: hairelandscapeconsultants.co.uk



Client:
Pontllanfraith
Comprehensive School

Project name:
Sketch Landscape
Proposals

Scale:	Date:	Drawn by:	Checked by:
NTS@A3	Sept '22	KH	-

Drawing no. 687/01